

Ultra X Plus

132 HALF-CELL MONOFACIAL MODULE

650-670W

STPXXXS - D66/Wmh

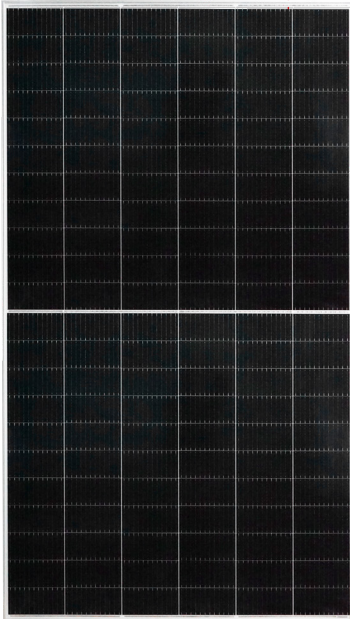

Features



High module conversion efficiency

Module efficiency up to 21.6 % achieved through advanced cell technology and manufacturing process



Suntech current sorting process

Up to 2 % power loss caused by current mismatch could be diminished by current sorting technique to maximize system power output



Excellent weak light performance

More power output in weak light condition, such as cloudy, morning and sunset



Lower operating temperature

Lower operating temperature and temperature coefficient increases the power output



Extended wind and snow load tests

Module certified to withstand extreme wind (2400 Pascal) and snow loads (5400 Pascal) *



Withstanding harsh environment

Reliable quality leads to a better sustainability even in harsh environment like desert, farm and coastline

Certifications and standards:
IEC 61215, IEC 61730, conformity to CE



Trust Suntech to Deliver Reliable Performance Over Time

- World-class manufacturer of crystalline silicon photovoltaic modules
- Rigorous quality control meeting the highest international standards: ISO 9001, ISO 14001 and ISO17025
- Regular independently checked production process from international accredited institute/company
- Tested for harsh environments (IEC 61701, IEC 62716, DIN EN 60068-2-68) ***
- Long-term reliability tests
- 2 x 100% EL inspection ensuring defect-free modules

HD technology + Half-Cell

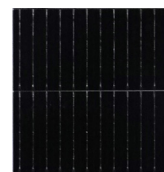

Half-cell with MBB design decreases internal resistance while boosts power output; narrowed inter-cell gap through flexible welding technology contributes to the module's compact dimension.

Industry-leading Warranty based on nominal power

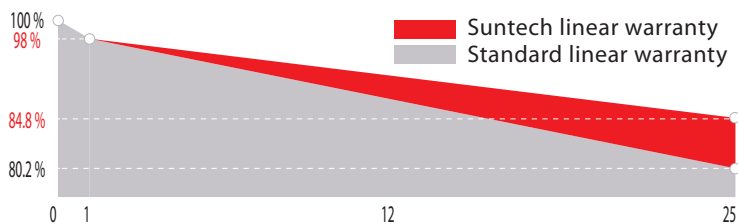

First year power degradation -2.0%

Annual degradation -0.55%

Product warranty 12 years

linear warranty 25 years

IP68 Rated Junction Box



The Suntech IP68 rated junction box ensures an outstanding waterproof level, supports installations in all orientations and reduces stress on the cables.

* Please refer to Suntech Standard Module Installation Manual for details.
** WEEE only for EU market. *** Please refer to Suntech Product Near-coast Installation Guide for details.
**** Please refer to Suntech Limited Warranty for details.

Electrical Characteristics

STC	STPXXXS-D66/Wmh				
Maximum Power at STC (Pmax)	670W	665W	660W	655W	650W
Optimum Operating Voltage (Vmp)	38.45V	38.25V	38.05V	37.85V	37.65V
Optimum Operating Current (Imp)	17.43A	17.39A	17.35A	17.31A	17.27A
Open Circuit Voltage (Voc)	46.45V	46.25V	46.05V	45.85V	45.65V
Short Circuit Current (Isc)	18.43A	18.39A	18.35A	18.31A	18.27A
Module Efficiency	21.6%	21.4%	21.2%	21.1%	20.9%
Operating Module Temperature	-40 °C to +85 °C				
Maximum System Voltage	1500 V DC (IEC)				
Maximum Series Fuse Rating	30 A				
Power Tolerance	0/+5 W				

STC: Irradiance 1000 W/m², module temperature 25 °C, AM=1.5;
Tolerance of Pmax is within +/- 3%;
For tracker installation, please turn to Suntech for mechanical load information.

NMOT	STPXXXS-D66/Wmh				
Maximum Power at NMOT (Pmax)	505.5W	501.7W	497.9W	494.1W	490.3W
Optimum Operating Voltage (Vmp)	35.8V	35.7V	35.6V	35.4V	35.2V
Optimum Operating Current (Imp)	14.1A	14.07A	13.99A	13.96A	13.92A
Open Circuit Voltage (Voc)	43.7V	43.5V	43.4V	43.2V	43.0V
Short Circuit Current (Isc)	14.87A	14.84A	14.76A	14.73A	14.70A

NMOT: Irradiance 800 W/m², ambient temperature 20 °C, AM=1.5, wind speed 1 m/s.

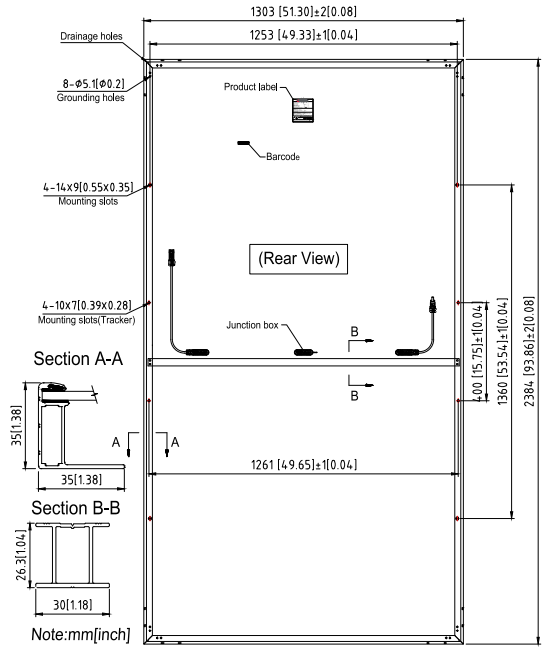

Temperature Characteristics

Nominal Module Operating Temperature (NMOT)	42 ± 2 °C
Temperature Coefficient of Pmax	-0.36%/°C
Temperature Coefficient of Voc	-0.304%/°C
Temperature Coefficient of Isc	0.050%/°C

Mechanical Characteristics

Solar Cell	Monocrystalline silicon 210 mm
No. of Cells	132 (6 × 22)
Dimensions	2384 × 1303 × 35 mm (93.9 × 51.3 × 1.4 inches)
Weight	34.5 kgs (76.1 lbs.)
Front Glass	3.2 mm (0.126 inches) fully tempered glass
Frame	Anodized aluminium alloy
Junction Box	IP68 rated (3 bypass diodes)
Output Cables	4.0 mm ² , Portrait: (-) 350 mm and (+) 160 mm in length or customized length

Packing Configuration

Container	40' HC
Pieces per container	558
Packaging box dimensions	1332×1130×2500 mm
Packaging box weight	1140 kg

Current-Voltage & Power-Voltage Curve (670S)

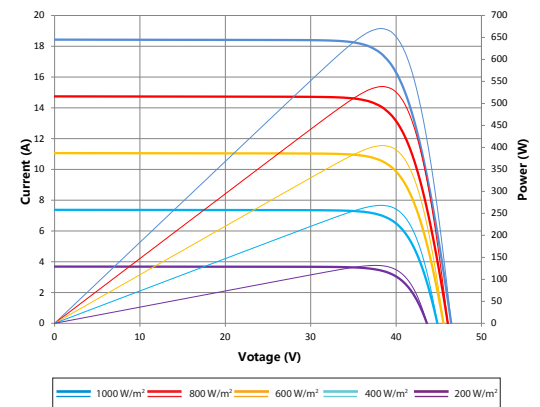

Dealer information

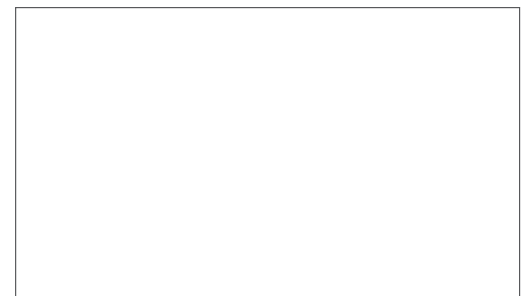

Information on how to install and operate this product is available in the installation instruction. All values indicated in this data sheet are subject to change without prior announcement. The specifications may vary slightly. All specifications are in accordance with standard EN 50380. Color differences of the modules relative to the figures as well as discolorations of/in the modules which do not impair their proper functioning are possible and do not constitute a deviation from the specification.